

# SARS-COV-2 (COVID-19) PCR

## Collection Instructions

### Materials Required

- 1 Sterile nasopharyngeal swab (thinner swab)
- 1 Sterile oropharyngeal swab (thicker swab)
- 1 Sterile virus transport media (collection tube)
- 1 Biohazard bag
- 1 Absorbent sheet
- 1 Parafilm sealing sheet
- 2 Barcode labels

### Return supplies:

- UN3373 Biological substance, Category "B" stamped FedEx Clinical pak
- Corrugated return box
- FedEx Return label

## Collection Procedures

*Please be aware that Nasopharyngeal collection is preferred over Oropharyngeal collection.*

### NASOPHARYNGEAL COLLECTION

1. Wash hands thoroughly.
2. Please have the patient blow their nose to remove excess mucus.
3. Tilt head back 70 degrees, and gently pass the nasal (thinner) swab through the nose until resistance is encountered or the distance is equivalent to that from nostrils to outer opening of the ear.
4. Leave swab in for several seconds to absorb secretions. Slowly remove swab while rotating.
5. Insert the swab into the vial, making sure the swab tip is covered by the liquid in the vial. The tip of the swab must be immersed in liquid.
6. Snap off the swab at the score mark, and secure cap on the vial, making sure no fluid will leak out of the vial.
7. Please keep the vial in an upright position for 10–15
8. minutes before preparing the sample for shipping back to the lab.

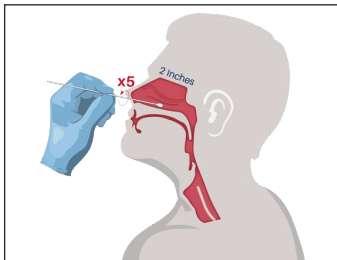

Nasopharyngeal Collection

### OROPHARYNGEAL COLLECTION

1. Wash hands thoroughly.
2. Insert the oral (thicker) swab into the posterior pharynx and tonsillar areas.
3. Rub swab over both tonsillar pillars and posterior oropharynx and avoid touching the tongue, teeth, and gums.
4. Place swab, tip first, into the sterile viral transport tube provided.
5. Snap off the swab at the score mark, and secure cap on the vial, making sure no fluid will leak out of the vial.
6. Please keep the vial in an upright position for 10–15 minutes before preparing the sample for shipping back to the lab.

### SALIVA COLLECTION

1. Wash hands thoroughly.
2. Patient should not eat, drink, smoke, or chew gum for 30 minutes prior to collection.
3. Have the patient fill the tube with saliva to the black wavy line, excluding bubbles.
4. Remove the funnel cap and close with fluid cap. Screw tightly to release blue DNA stabilization solution.
5. Shake the tube for at least 5 seconds to mix the solution with the specimen.

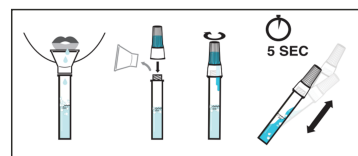

Saliva Collection

### Safety Information:

- Always wear appropriate protective equipment when handling any clinical specimen. These include lab coats, disposable gloves, and a face mask.
- Do not touch your face when handling specimens. Periodically change gloves and disinfect surfaces with 10% bleach and 70% ethanol.
- Always wash hands thoroughly with soap after handling specimens.